

# MiniACE Button

## Low Profile Antegrade Continence Enema Button

The Bowel Management Device is intended to instill fluids through a stoma into the colon to promote evacuation of the contents of the lower bowel through the anus and is intended to be an aid in the management of faecal incontinence. The catheter is placed and maintained in a percutaneously prepared opening, such as a caecostomy or appendicostomy. The Bowel Management Device is intended to be used in children and adults.

### Replacing the MiniACE button

To ensure a proper fit it is crucial to measure the stoma length – this is not a substitute for the instructions for use.

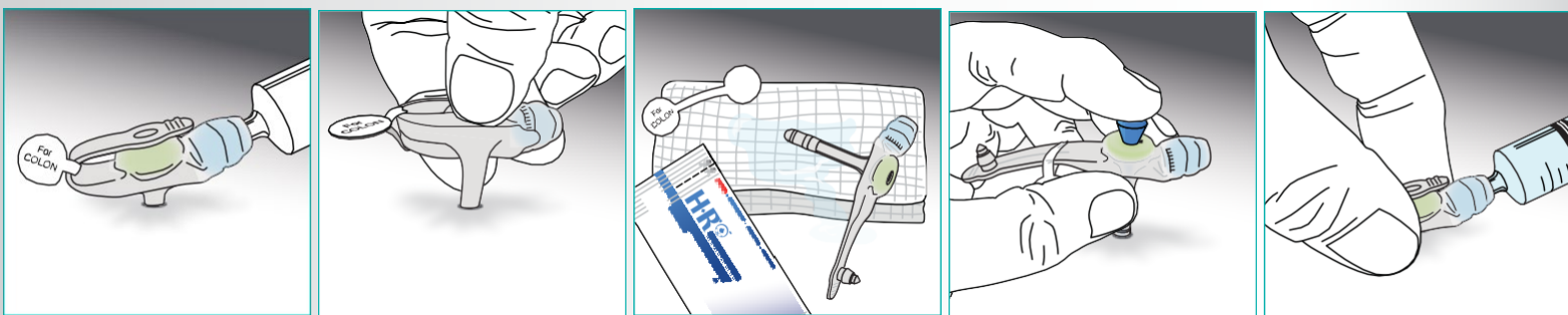

**DEFLATE THE BALLOON**  
Deflate the existing device using a luer lock syringe

**REMOVE DEVICE**  
Remove the device gently, pull up on the device with slow & steady pressure

**PREPARE KIT**  
Prepare the new device, apply a water soluble lubricant to the device

**INSERT DEVICE**  
Insert the device into the stoma site, until it is flush against the skin. Remove the blue stiffener.

**INFLATE THE BALLOON**  
Fill the balloon to the recommended fill volume which is printed on the balloon fill valve.

### Irrigation Set Attachment

The connection between the MiniACE button and its irrigation set is ten times stronger than the competition <sup>1</sup>

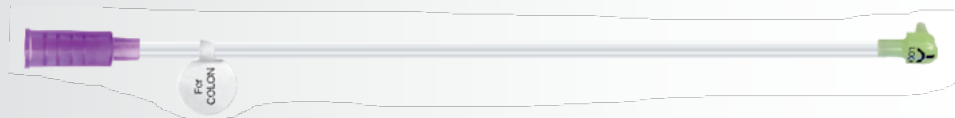

Legacy Irrigation Set (2-1221)

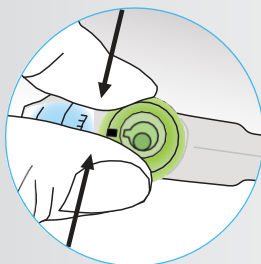

**STABILISE**  
Stabilise the device

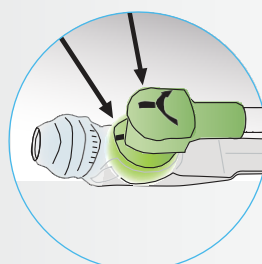

**INSERT**  
Insert connector end

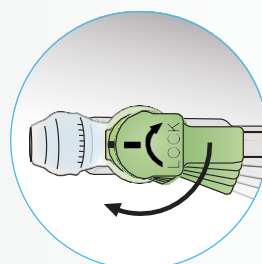

**ROTATE**  
Rotate the connector ¾ to the right

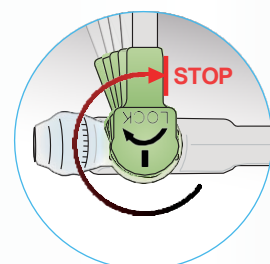

**STABILISE**  
Lock the connector into place, now the device is ready to irrigate

# MiniACE Button

*Low Profile Antegrade Continence Enema Button*

MiniACE

Competitor

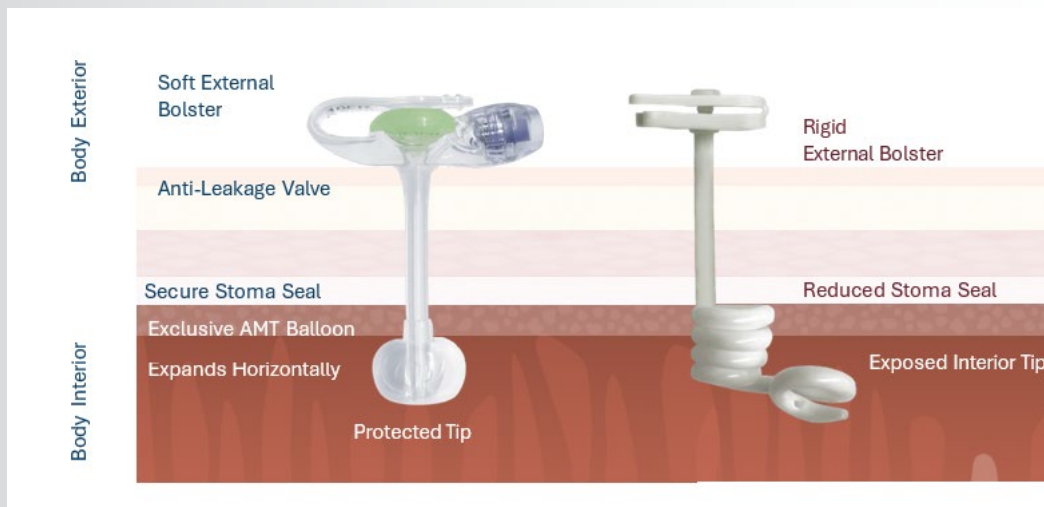

	10F	12F	14F
LENGTH (cm)	ENFIT® ORDER #	ENFIT® ORDER #	ENFIT® ORDER #
0.8	ACE-1008-I	ACE-1208-I	ACE-1408-I
1	ACE-1010-I	ACE-1210-I	ACE-1410-I
1.2	ACE-1012-I	ACE-1212-I	ACE-1412-I
1.5	ACE-1015-I	ACE-1215-I	ACE-1415-I
1.7	ACE-1017-I	ACE-1217-I	ACE-1417-I
2	ACE-1020-I	ACE-1220-I	ACE-1420-I
2.3	ACE-1023-I	ACE-1223-I	ACE-1423-I
2.5	ACE-1025-I	ACE-1225-I	ACE-1425-I
2.7	ACE-1027-I	ACE-1227-I	ACE-1427-I
3	ACE-1030-I	ACE-1230-I	ACE-1430-I
3.5	ACE-1035-I	ACE-1235-I	ACE-1435-I
4	ACE-1040-I	ACE-1240-I	ACE-1440-I
4.4	ACE-1044-I	ACE-1244-I	ACE-1444-I
5	ACE-1050-I	ACE-1250-I	ACE-1450-I
5.5	ACE-1055-I	ACE-1255-I	ACE-1455-I
6	ACE-1060-I	ACE-1260-I	ACE-1460-I
6.5	ACE-1065-I	ACE-1265-I	ACE-1465-I
7	ACE-1070-I	ACE-1270-I	ACE-1470-I
8	ACE-1080-I	ACE-1280-I	ACE-1480-I
9	ACE-1090-I	ACE-1290-I	ACE-1490-I
10	ACE-10100-I	ACE-12100-I	ACE-14100-I

Balloon Inflation Volumes			
Fr Size	Minimum Fill Volume	Recommended Fill Volume	Maximum Fill Volume
10F	1.5ml	2ml	2.5ml
12F	2ml	2.5ml	3ml
14F	3ml	4ml	5ml

Inflate the balloon with sterile or distilled water according to the fill volume

