

# MiniONE – Replacing the Balloon Button

## Replacing The MiniONE® Balloon Button

The MiniONE® balloon Button should be changed at least every 3 months, or as often as suggested by your healthcare professional. Each tube will last a different amount of time depending on the patient.

### Place The New Device:

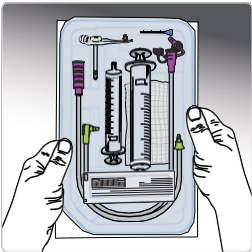

Be sure you have the correct MiniONE® Button size. Verify that the French size and stoma length of the replacement device match what is prescribed by your physician.

**NOTE:** It is important to have the stoma site re-measured on a regular basis. For optimal device performance, the stoma site should be measured every 6-12 months or after any significant change to weight/height that impacts how the device fits.

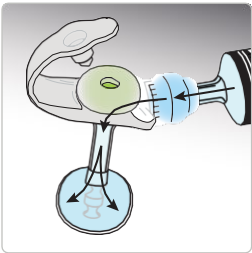

Prior to placing the new MiniONE® Button, inflate the balloon to the recommended fill volume using distilled or sterile water. (See MiniONE® Balloon Button Fill Volume Table on page 16).

Verify that there are no signs of leakage from the balloon and that the balloon is symmetrical in shape. A balloon can be gently massaged with fingers into a symmetrical shape if it is not excessively misshaped. Deflate the balloon once inspection is complete.

### REMOVE THE EXISTING DEVICE:

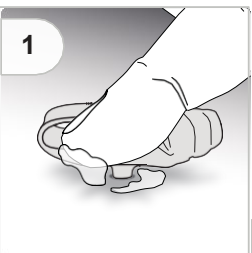

Lubricate the stoma tract with a water soluble lubricant. To distribute the lubricant, rotate the existing button and move the button up and down.

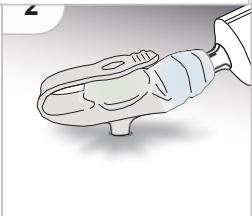

Deflate the retention balloon by inserting a syringe into the balloon fill port and withdrawing the water. The balloon fill port on 12-14F MiniONE® Balloon Buttons is compatible with both Luer (slip tip) and Luer lock syringes; the balloon fill port on 16-24F devices is compatible with a slip tip syringe.

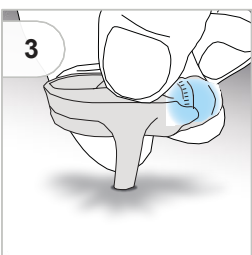

Pull up and gently remove the device from the stoma site with slow, steady pressure.

## Place The New Device:

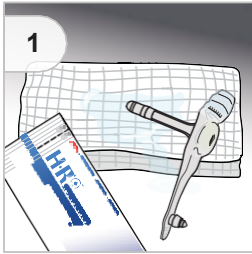

Apply a water soluble lubricant to the tip of the MiniONE® Device (a packet of lubricant is included in the MiniONE® device kit (but not the Mini Classic kit).

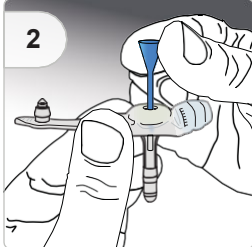

**NOTE:** The blue stiffener is included with 12F-18F MiniONE® Balloon Button. The blue stiffener is NOT included with 20F-24F MiniONE® Balloon Button Kits

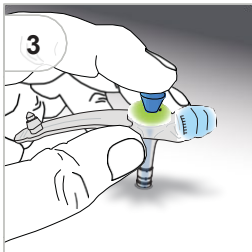

Gently press the tip of the MiniONE® through the stoma and into the stomach until the outside of the tube is flat against the skin.

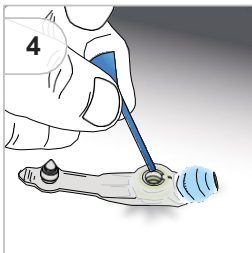

Remove the blue stiffener (if used in step 2-3).

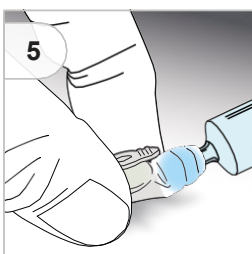

Fill a syringe with the correct volume of water. The balloon fill port on 12-14F MiniONE® Balloon Buttons is compatible with ENFit syringes; the balloon fill port on 16-24F devices is compatible with a slip tip syringe. Insert the syringe into the balloon fill port of the MiniONE® and inflate the balloon to the recommended fill volume listed in the MiniONE® Balloon Button Fill Volume Table. The recommended fill volume is printed on the balloon fill port of the MiniONE®.

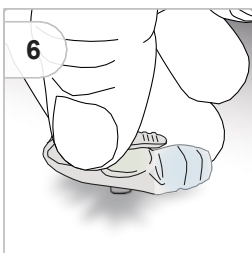

Gently pull on the G-Tube and check for signs of gastric leaking.



For a complete list of products, visit us at <https://www.kebomed.co.uk/products/amt-enteral-devices/>

Kebomed UK  
Swaines Hill Manor  
Estate Offices, Swaines Hill  
Alton Hants GU34 4DP

01884 266377 | [enteral.sales@kebomed.co.uk](mailto:enteral.sales@kebomed.co.uk)

KEBOMED